

## 外形尺寸图表 / OUTLINE DIMENSION SHEET

### PGC 160-L1

输出端/OUTPUT

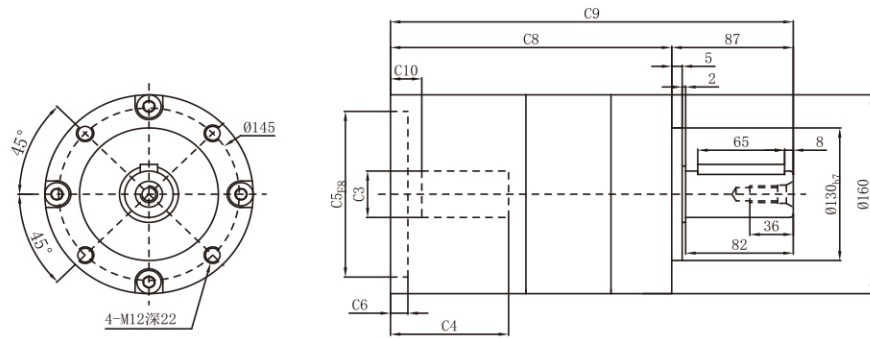

输入端/INPUT

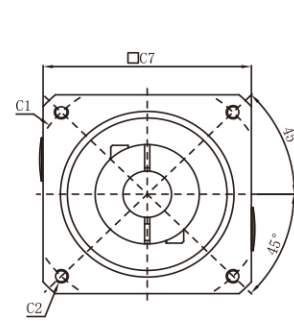

### PGC 160-L2

输出端/OUTPUT

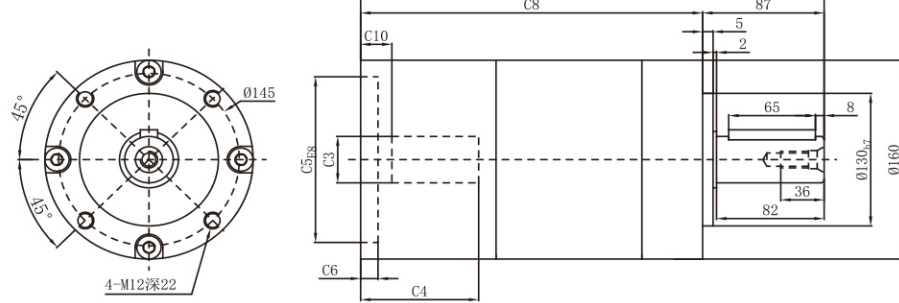

输入端/INPUT

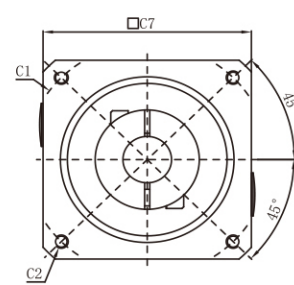

### 输出轴径/Output Diameter

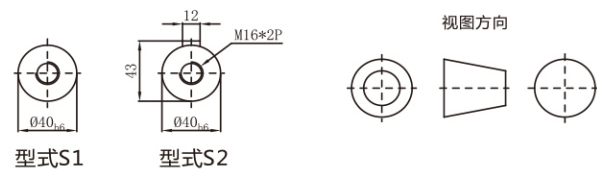

\*输入马达连接板之尺寸, 可根据客户要求单独定做。  
\*The input motor specific dimensions could be customised.

尺寸	C1	C2	C3	C4	C5	C6	C7	C8	C9	C10
PGC160-L1	φ 145	4-M8x20	≤ φ 24	81	φ 110	10	142	173	260	19.5
	φ 165	4-M10x25, 4-M12x35	≤ φ 32	81	φ 130	10	142	173	260	19.5
	φ 200	4-M12x35	≤ φ 42	83	φ 114.3	8	180	173	260	21.5
	φ 200	4-M12x35	≤ φ 42	115	φ 114.3	8	180	205	292	53.5
	φ 215	4-M12x35, 4-M14x35	≤ φ 42	83	φ 180	8	190	173	260	21.5
PGC160-L2	φ 145	4-M8x20	≤ φ 24	81	φ 110	10	142	243	330	19.5
	φ 165	4-M10x25, 4-M12x35	≤ φ 32	81	φ 130	10	142	243	330	19.5
	φ 200	4-M12x35	≤ φ 42	83	φ 114.3	8	180	243	330	21.5
	φ 200	4-M12x35	≤ φ 42	115	φ 114.3	8	180	275	362	53.5
	φ 215	4-M12x35, 4-M14x35	≤ φ 42	83	φ 180	8	190	243	330	21.5

\* C1~C10是公制标准马达连接板之尺寸, 可根据客户要求单独定做。  
\* C1~C10 are motor (metric standard) specific dimensions, which could be customised.



## PGE 直齿系列



减速机性能资料 / GEAR BOX PERFORMANCE INFORMATION

规格Specifications	单位unit	节数Stage	减速比Ratio	PGE060	PGE080	PGE090	PGE120	PGE160
额定输出力矩T2N Nominal Output Torque	N.m	1	3	32.6	85.7	95.2	283	482
			4	30.1	67.1	74.6	249	490
			5	32.3	85.7	95.2	283	473
			7	30.9	77.0	85.6	219	400
		2	10	25.0	67.5	75.0	210	320
			12	32.6	85.7	95.2	283	482
			15	32.6	85.7	95.2	283	482
			20	30.1	67.1	74.6	249	490
			25	32.3	85.7	95.2	283	473
			30	32.3	85.7	95.2	283	473
			35	32.3	85.7	95.2	283	473
			40	32.3	85.7	95.2	283	473
			50	32.3	85.7	95.2	283	473
			70	30.9	76.5	85.0	219	400
100	25.0	67.5	75.0	210	320			
急停力矩T2NOT Emergency Stop Torque	N.m	1、2	3 ~ 100	3倍额定输出力矩 (3.0 times of Nominal Output Torque)				
额定输入转速n1 Nominal Input Speed	rpm	1、2	3 ~ 100	3000	3000	3000	2500	2000
最大输入转速n1max Max.Input Speed	rpm	1、2	3 ~ 100	6000	6000	6000	5000	4000
超精密背隙P0 Ultraprecise Backlash	arcmin	1	3 ~ 10	-	-	-	≤3	≤3
		2	12 ~ 100	-	-	-	≤5	≤5
精密背隙P1 Precise Backlash	arcmin	1	3 ~ 10	-	≤6	≤6	≤5	≤5
		2	12 ~ 100	-	≤9	≤9	≤7	≤7
标准背隙P2 Standard Backlash	arcmin	1	3 ~ 10	≤12	≤9	≤9	≤7	≤7
		2	12 ~ 100	≤15	≤12	≤12	≤9	≤9
扭转刚性 Torsional Rigidity	N.m /arcmin	1、2	3 ~ 100	2.6	6.75	7.5	15.5	30
容许径向力F2rB Max.Radial Load	N	1、2	3 ~ 100	889	1467	1630	3380	6450
容许轴向力F2aB Max.Axial Load	N	1、2	3 ~ 100	850	1278	1420	2930	5510
使用温度 Operating Temp	° C	1、2	3 ~ 100	-10° C ~ +90° C				
使用寿命 Service Life	hr	1、2	3 ~ 100	20,000 (10,000/连续运转continuu operatong)				
效率η Efficiency	%	1	3 ~ 10	≥96%				
		2	12 ~ 100	≥92%				
重量 Weight	kg	1	3 ~ 10	1.3	2.7	3.0	7.3	15.6
		2	12 ~ 100	2.0	4.5	5.0	11.5	20.7
安装方向 mounting Position	-	1、2	3 ~ 100	任意方向 Any direction				
噪音值 Noise Level	dBA/1m	1、2	3 ~ 100	60	58.5	65	65	70
防护等级 Protection Class	-	1、2	3 ~ 100	Ip65				
润滑 Lubrication	-	1、2	3 ~ 100	全合成润滑脂油 Synthetic Lubricant				

减速机转动惯量

规格Specifications	单位unit	节数Stage	减速比Ratio	PGE060	PGE080	PGE090	PGE120	PGE160
转动惯量J1 Inertia	kg.cm <sup>2</sup>	1	3	0.25	0.73	0.81	2.2	7.89
			4	0.18	0.59	0.65	1.8	5.83
			5	0.16	0.56	0.62	1.61	5.83
			7	0.14	0.54	0.60	1.55	5.22
		2	10	0.14	0.54	0.60	1.53	5.20
			12	0.16	0.56	0.62	1.61	5.83
			15	0.16	0.56	0.62	1.61	5.83
			20	0.16	0.56	0.62	1.61	5.83
			25	0.16	0.56	0.62	1.61	5.83
			30	0.14	0.54	0.60	1.55	5.22
			35	0.14	0.54	0.60	1.55	5.22
			40	0.14	0.54	0.60	1.55	5.22
			50	0.14	0.54	0.60	1.55	5.22
			70	0.14	0.54	0.60	1.53	5.20
100	0.14	0.54	0.60	1.53	5.20			

外形尺寸图表 / OUTLINE DIMENSION SHEET

PGE 060-L1

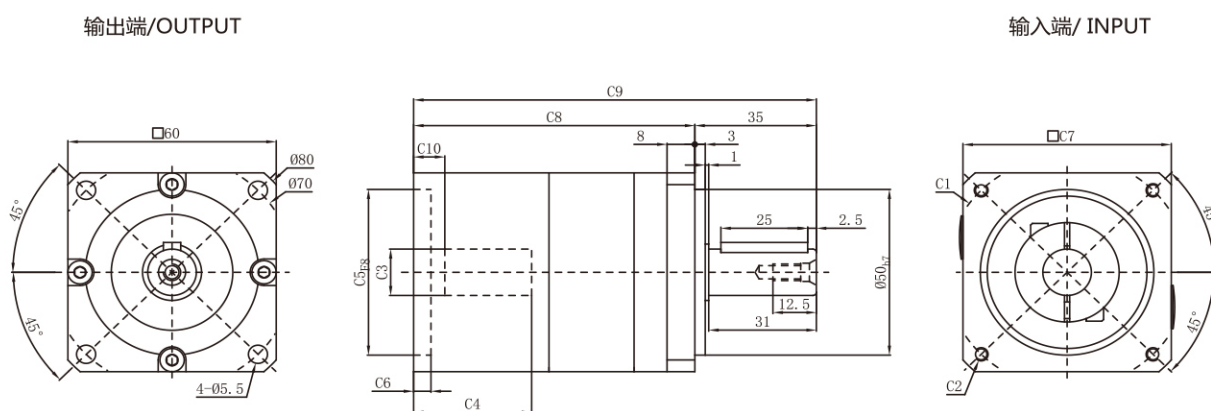

PGE 060-L2

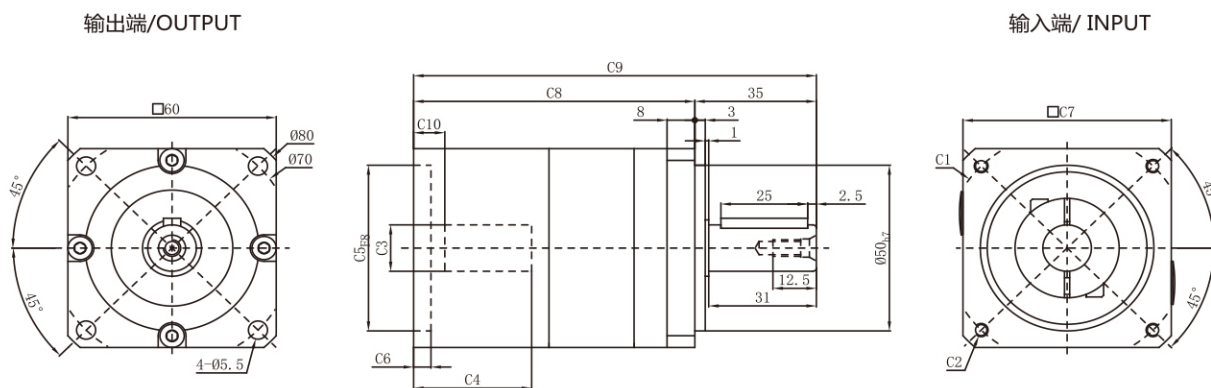

输出轴径/Output Diameter

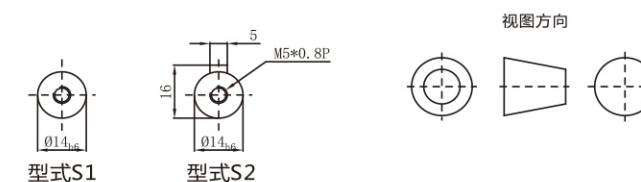

\*输入马达连接板之尺寸, 可根据客户要求单独定做。  
\*The input motor specific dimensions could be customised.

尺寸	C1	C2	C3	C4	C5	C6	C7	C8	C9	C10
PGE 060-L1	φ 46	4-M4x10	≤ φ 8	34	φ 30	5	60	81	116	9
	φ 66.7	4-M4x10	≤ φ 8	34	φ 38.1	5	60	81	116	8
PGE 060-L2	φ 70	4-M4x10,4-M5x12	≤ φ 14	34	φ 50	5	60	81	116	9
	φ 46	4-M4x10	≤ φ 8	34	φ 30	5	60	137.5	172.5	9
	φ 66.7	4-M4x10	≤ φ 8	34	φ 38.1	5	60	137.5	172.5	8
	φ 70	4-M4x10,4-M5x12	≤ φ 14	34	φ 50	5	60	137.5	172.5	9

\* C1~C10是公制标准马达连接板之尺寸, 可根据客户要求单独定做。  
\* C1~C10are motor (metric standard) specific dimensions, which could be customised.

外形尺寸图表 / OUTLINE DIMENSION SHEET

PGE080-L1

输出端/OUTPUT

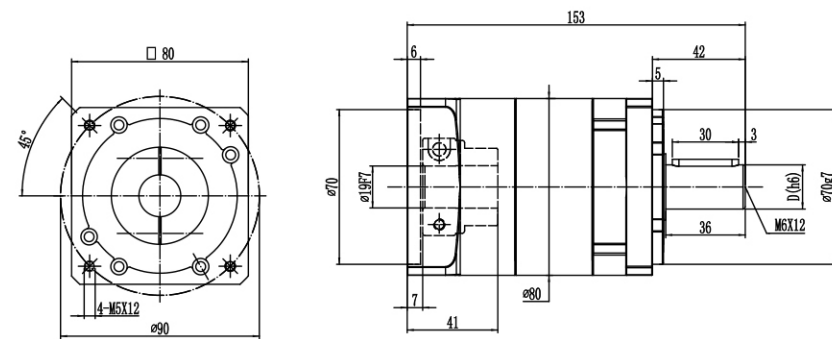

输入端/INPUT

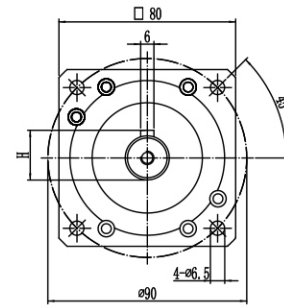

PGE080-L2

输出端/OUTPUT

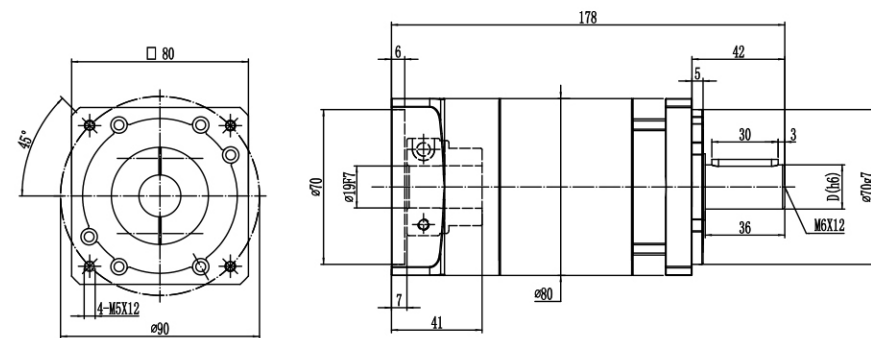

输入端/INPUT

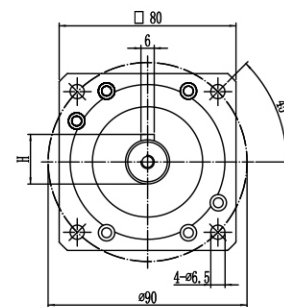

输出轴径/Output Diameter

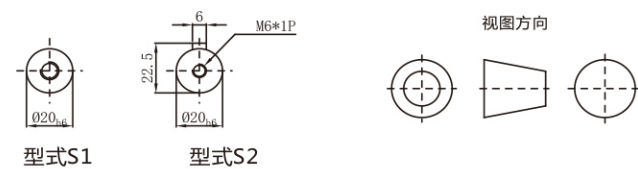

\*输入马达连接板之尺寸, 可根据客户要求单独定做。  
\*The input motor specific dimensions could be customised.

外形尺寸图表 / OUTLINE DIMENSION SHEET

PGE090-L1

输出端/OUTPUT

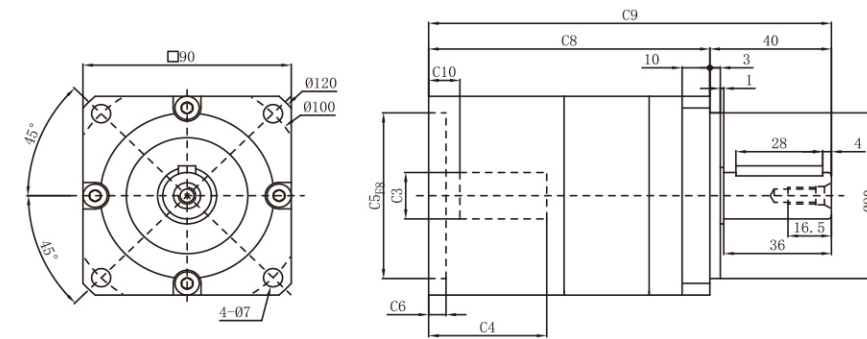

输入端/INPUT

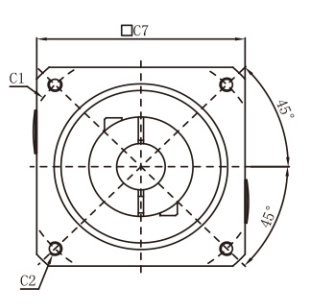

PGE090-L2

输出端/OUTPUT

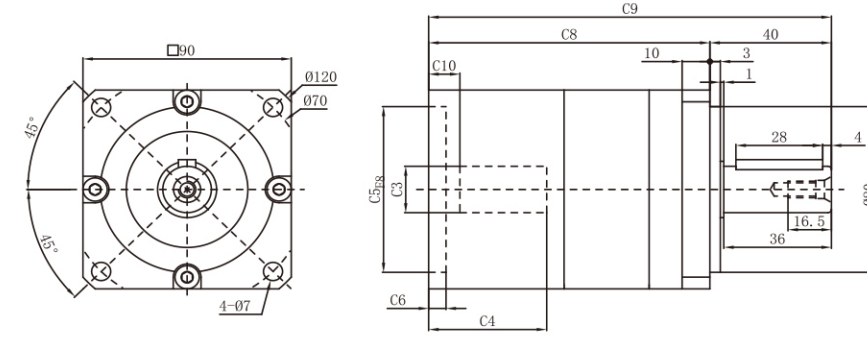

输入端/INPUT

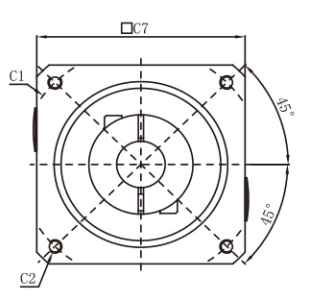

输出轴径/Output Diameter

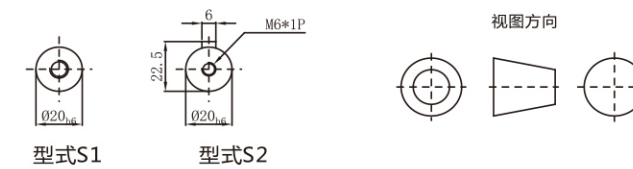

\*输入马达连接板之尺寸, 可根据客户要求单独定做。  
\*The input motor specific dimensions could be customised.

尺寸	C1	C2	C3	C4	C5	C6	C7	C8	C9	C10
PGE090-L1	φ 70	4-M4x12,4-M5x12	≤ φ 14	46	φ 50	4	90	100	140	6
	φ 75	4-M4x12,4-M5x12	≤ φ 14	46	φ 60	5.5	90	100	1	6
	φ 90	4-M5x15,4-M6x15	≤ φ 19	46	φ 70	7	90	100	140	7
	φ 100	4-M6x15	≤ φ 19	46	φ 80	7	90	100	1	7
	φ 115	4-M8x20	≤ φ 24	61.5	φ 95	10	100	100	140	12.5
PGE090-L2	φ 70	4-M4x12,4-M5x12	≤ φ 14	46	φ 50	4	90	119	159	6
	φ 75	4-M4x12,4-M5x12	≤ φ 14	46	φ 60	5.5	90	119	1	6
	φ 90	4-M5x15,4-M6x15	≤ φ 19	46	φ 70	7	90	119	159	7
	φ 100	4-M6x15	≤ φ 19	46	φ 80	7	90	119	1	7
	φ 115	4-M8x20	≤ φ 24	61.5	φ 95	10	100	119	159	12.5
	φ 145	4-M8x20	≤ φ 24	61.5	φ 110	10	130	119	1	12.5

\* C1~C10是公制标准马达连接板之尺寸,可根据客户要求单独定做。  
\* C1~C10are motor (metric standard) specific dimensions, which could be customised.

尺寸	C1	C2	C3	C4	C5	C6	C7	C8	C9	C10
PGE090-L1	φ 70	4-M4x12,4-M5x12	≤ φ 14	46	φ 50	4	90	100	140	6
	φ 75	4-M4x12,4-M5x12	≤ φ 14	46	φ 60	5.5	90	100	1	6
	φ 90	4-M5x15,4-M6x15	≤ φ 19	46	φ 70	7	90	100	140	7
	φ 100	4-M6x15	≤ φ 19	46	φ 80	7	90	100	1	7
	φ 115	4-M8x20	≤ φ 24	61.5	φ 95	10	100	100	140	12.5
PGE090-L2	φ 70	4-M4x12,4-M5x12	≤ φ 14	46	φ 50	4	90	119	159	6
	φ 75	4-M4x12,4-M5x12	≤ φ 14	46	φ 60	5.5	90	119	1	6
	φ 90	4-M5x15,4-M6x15	≤ φ 19	46	φ 70	7	90	119	159	7
	φ 100	4-M6x15	≤ φ 19	46	φ 80	7	90	119	1	7
	φ 115	4-M8x20	≤ φ 24	61.5	φ 95	10	100	119	159	12.5
	φ 145	4-M8x20	≤ φ 24	61.5	φ 110	10	130	119	1	12.5

\* C1~C10是公制标准马达连接板之尺寸,可根据客户要求单独定做。  
\* C1~C10are motor (metric standard) specific dimensions, which could be customised.

外形尺寸图表 / OUTLINE DIMENSION SHEET

PGE 120-L1

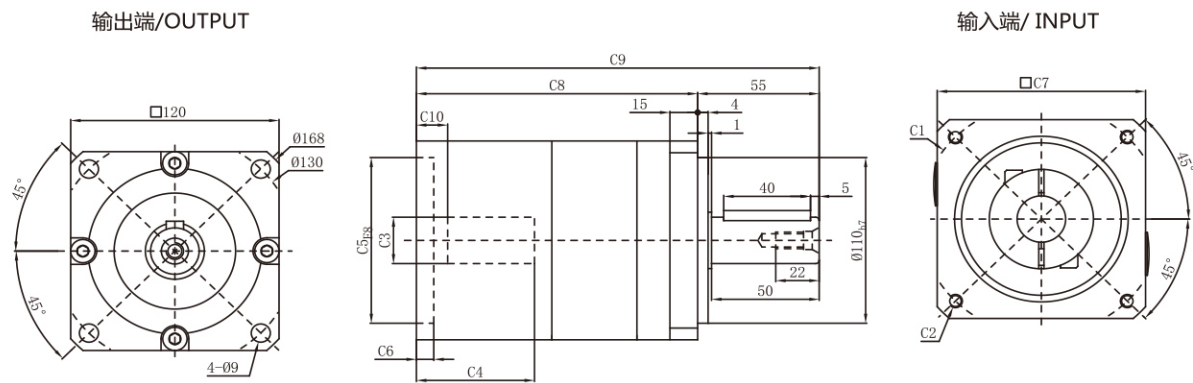

PGE 120-L2

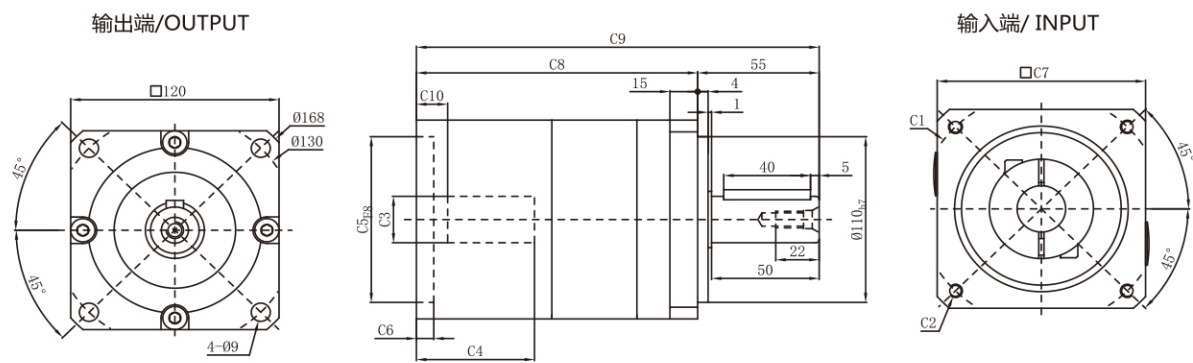

输出轴径/Output Diameter

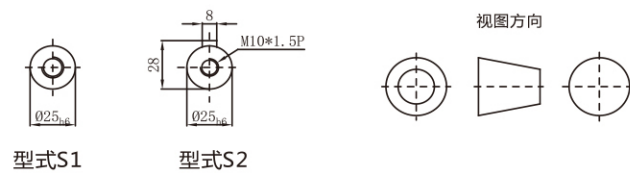

\*输入马达连接板之尺寸, 可根据客户要求单独定做。  
\*The input motor specific dimensions could be customised.

尺寸	C1	C2	C3	C4	C5	C6	C7	C8	C9	C10
PGE 120-L1	φ 90	4-M5x15, 4-M6x15	≤ φ 19	48.5	φ 70	7	115	153	208	7
	φ 100	4-M6x15	≤ φ 19	48.5	φ 80	7	115	153	2	7
	φ 115	4-M8x20	≤ φ 24	58	φ 95	10	115	153	208	11.5
	φ 145	4-M8x20	≤ φ 24	59	φ 110	10	130	153	2	12.5
	φ 145	4-M8x20	≤ φ 24	68	φ 110	10	130	162	217	21.5
PGE 120-L2	φ 90	4-M5x15, 4-M6x15	≤ φ 19	48.5	φ 70	7	115	180	2	7
	φ 100	4-M6x15	≤ φ 19	48.5	φ 80	7	115	180	235	7
	φ 115	4-M8x20	≤ φ 24	58	φ 95	10	115	180	235	11.5
	φ 145	4-M8x20	≤ φ 24	59	φ 110	10	130	180	235	12.5
	φ 145	4-M8x20	≤ φ 24	68	φ 110	10	130	189	244	21.5

\* C1~C10是公制标准马达连接板之尺寸, 可根据客户要求单独定做。  
\* C1~C10 are motor (metric standard) specific dimensions, which could be customised.

外形尺寸图表 / OUTLINE DIMENSION SHEET

PGE 160-L1

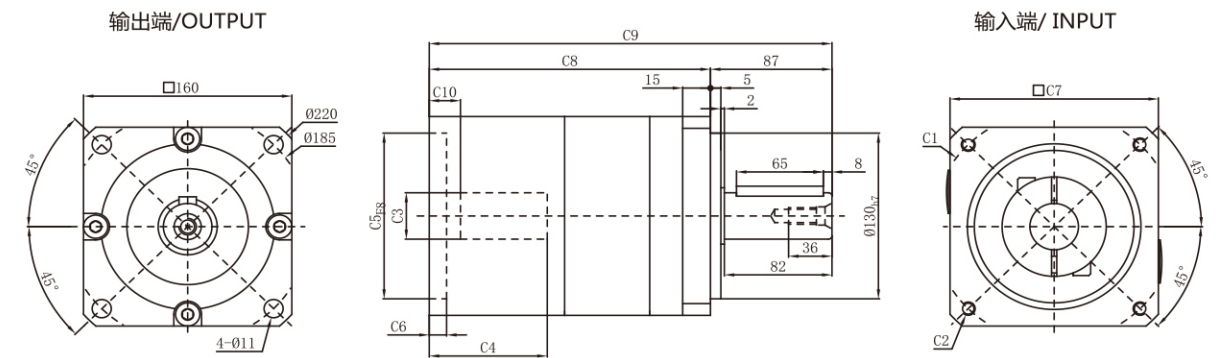

PGE 160-L2

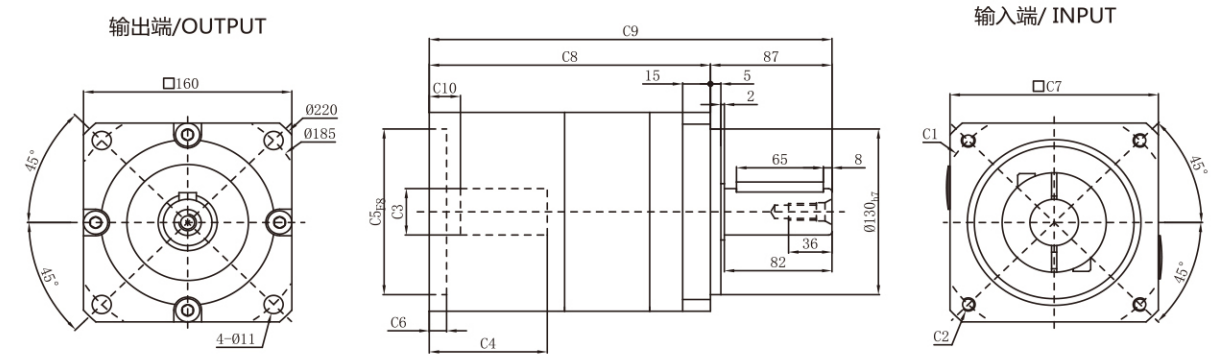

输出轴径/Output Diameter

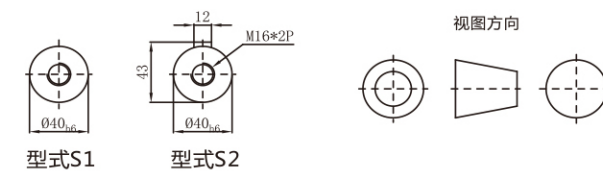

\*输入马达连接板之尺寸, 可根据客户要求单独定做。  
\*The input motor specific dimensions could be customised.

尺寸	C1	C2	C3	C4	C5	C6	C7	C8	C9	C10
PGE 160-L1	φ 145	4-M8x20	≤ φ 24	81	φ 110	10	142	173	260	19.5
	φ 165	4-M10x25, 4-M12x35	≤ φ 32	81	φ 130	10	142	173	260	19.5
	φ 200	4-M12x35	≤ φ 42	83	φ 114.3	8	180	173	260	21.5
	φ 200	4-M12x35	≤ φ 42	115	φ 114.3	8	180	205	292	53.5
	φ 215	4-M12x35, 4-M14x35	≤ φ 42	83	φ 180	8	190	173	260	21.5
PGE 160-L2	φ 145	4-M8x20	≤ φ 24	81	φ 110	10	142	243	330	19.5
	φ 165	4-M10x25, 4-M12x35	≤ φ 32	81	φ 130	10	142	243	330	19.5
	φ 200	4-M12x35	≤ φ 42	83	φ 114.3	8	180	243	330	21.5
	φ 200	4-M12x35	≤ φ 42	115	φ 114.3	8	180	275	362	53.5
	φ 215	4-M12x35, 4-M14x35	≤ φ 42	83	φ 180	8	190	243	330	21.5

\* C1~C10是公制标准马达连接板之尺寸, 可根据客户要求单独定做。  
\* C1~C10 are motor (metric standard) specific dimensions, which could be customised.